

Sampling accessory to distribute one sample stream to several instruments.

Sample Distribution Manifold

One sample inlet and two to four outlets to the instruments with manual shut-off valves.

Made of stainless steel SS316L.

Sample in- and outlets with female threads $\frac{1}{8}$ " for Swagelok connectors $\frac{1}{4}$ " tube or Serto 8 mm connections.

Optional pressure indicator made of stainless steel 0 ... 2.5 bar.

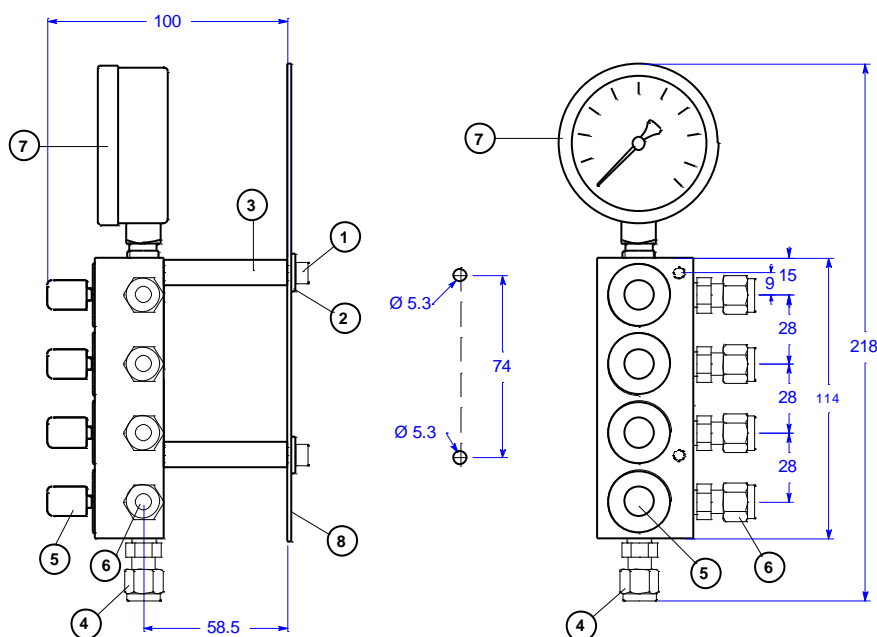

4-channel version with Swagelok connectors and manometer (side view and front view).

No.	Item
1	Hexagon socket screw, M5 x 60 mm, stainless steel 316
2	Washer M5, $\varnothing 5.3\text{mm} \times \varnothing 15\text{mm} \times 1.6\text{ mm}$, stainless steel 316
3	Distance sleeve, $\varnothing 10\text{ mm}$, length 50 mm, stainless steel 316
4	Sample in, e.g. Swagelok connector for $\frac{1}{4}$ " tubing
5	Shut-off valves (2 – 4 depending on configuration)
6	Sample out to instruments, e.g. Swagelok connectors for $\frac{1}{4}$ " tubing
7	Manometer 0 - 2.5 bar, stainless steel 1.4301 (option)
8	Mounting panel (not included)

Sample Requirements:

Sample temperature: 0 - 70 °C, short time max. 90 °C

Sample inlet pressure: max. 2.0 bar (28 psi)

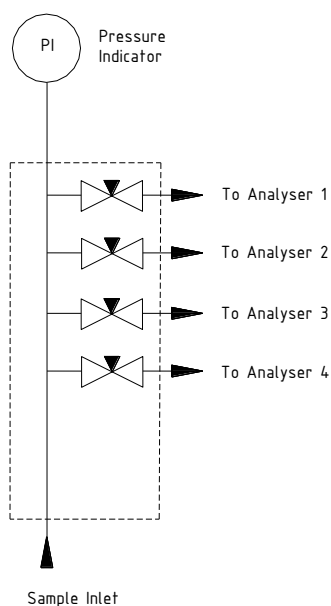

Schematic drawing
4-channel sample distribution manifold

Delivery

Sample Distribution Manifold without fittings (Swagelok respectively Serto connections for sample inlet respectively sample outlet are not scope of supply) ready for installation.

Available as 2-, 3- or 4-channel model (not upgradeable in the field).

Optional Manometer as pressure indicator

Order Nr.	Sample Distribution Manifold; 2 channel	A-82.572.000
	Sample Distribution Manifold; 3 channel	A-82.573.000
	Sample Distribution Manifold; 4 channel	A-82.574.000
Option:	<input type="checkbox"/> Pressure indicator (Manometer)	A-82.589.010